

Class 75 - Large Diameter Flanges ASME B16.47 Series B or API 605*

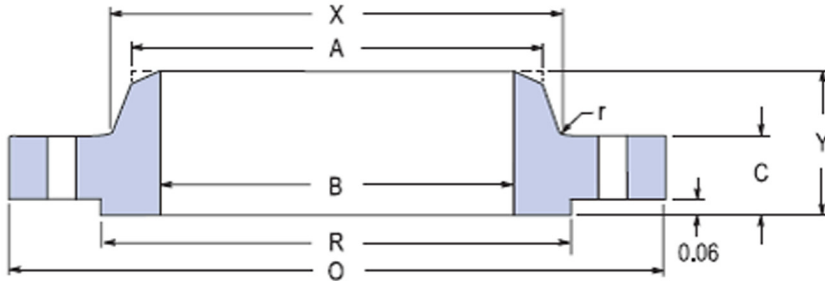

WELDING NECK



BLIND

Nominal Pipe Size	Flange								Bolting				Weights	
	OD	Thickness		Raised Face OD	Fillet Radius Min.	Hub			No. of Holes	Hole Size	Bolt Circle Dia.	Stud Bolt Diameter	Weld Neck Flange	Blind
		WN Flg	Blind*			Length	Bottom OD	Top OD						
O	C	C	R	r	Y	X	A							
class 75 LARGE DIAMETER FLANGES ASME B16.47 Series B or API 605*														
26	30.00	1.31	1.31	27.75	0.31	2.31	26.62	26.06	36	0.75	28.50	5/8	80	255
28	32.00	1.31	1.31	29.75	0.31	2.44	28.62	28.06	40	0.75	30.50	5/8	85	290
30	34.00	1.31	1.31	31.75	0.31	2.56	30.62	30.06	44	0.75	32.50	5/8	90	330
32	36.00	1.38	1.44	33.75	0.31	2.75	32.62	32.06	48	0.75	34.50	5/8	105	390
34	38.00	1.38	1.50	35.75	0.31	2.88	34.62	34.06	52	0.75	36.50	5/8	110	430
36	40.69	1.44	1.67	38.00	0.38	3.38	36.81	36.06	40	0.88	39.06	3/4	145	518
38	42.69	1.50	1.75	40.00	0.38	3.50	38.81	38.06	40	0.88	41.06	3/4	160	595
40	44.69	1.50	1.75	42.00	0.38	3.62	40.81	40.06	44	0.88	43.06	3/4	170	760
42	46.69	1.56	1.88	44.00	0.38	3.75	42.81	42.06	48	0.88	45.06	3/4	185	895
44	49.25	1.69	1.94	46.25	0.38	4.12	44.88	44.06	36	1.00	47.38	7/8	230	1065
46	51.25	1.75	2.00	48.25	0.38	4.25	46.88	46.06	40	1.00	49.38	7/8	245	1185
48	53.25	1.81	2.12	50.25	0.38	4.38	48.88	48.06	44	1.00	51.38	7/8	270	1315
50	55.25	1.88	2.18	52.25	0.38	4.56	50.94	50.06	44	1.00	53.38	7/8	290	1505
52	57.38	1.88	2.25	54.25	0.38	4.75	52.94	52.06	48	1.00	55.50	7/8	310	1665
54	59.38	1.94	2.38	56.25	0.38	4.94	55.00	54.06	48	1.00	57.50	7/8	340	1840
56	62.00	2.00	2.44	58.25	0.44	5.31	57.12	56.06	40	1.12	59.88	1	400	2110
58	64.00	2.06	2.50	60.50	0.44	5.44	59.12	58.06	44	1.12	61.88	1	430	2300
60	66.00	2.19	2.62	62.50	0.44	5.69	61.12	60.06	44	1.12	63.88	1	475	2500

NOTE

*Blinds are not included in API 605.